

Area of Application:

Turret

## Vacuum & Highflow

Max. working pressure 16 bar

Details:

High flow/Vacuum headwork open/close 1,5x360°

3-Zone colour, acc. to EN13792:2002

Fixed nozzle

Materials in media contact:

## Brass

PP

Rubber, FKM

Perfluoropolyether based lubricant

SPX (Soft PEX)

PVDF

Mounting:

M30x1,5 nut with locking pins, O-ring and washer (See 94G0232)

Inlet / outlet connection:

DN8 hose with G1/2" female connection

DIN 12 898 hose nozzle

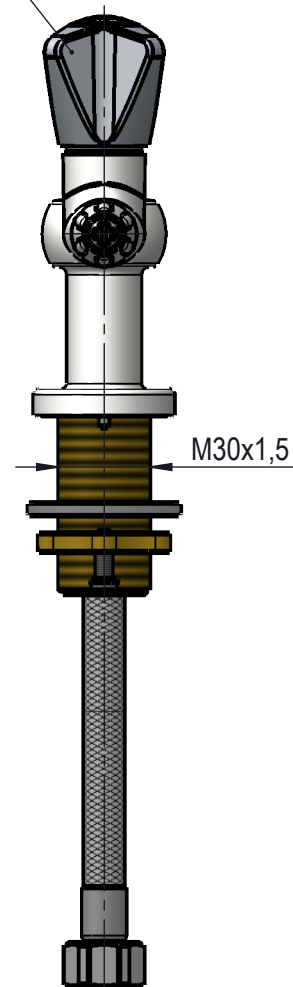

M30x1,5

ISO228/1-G1/2"  
female inlet

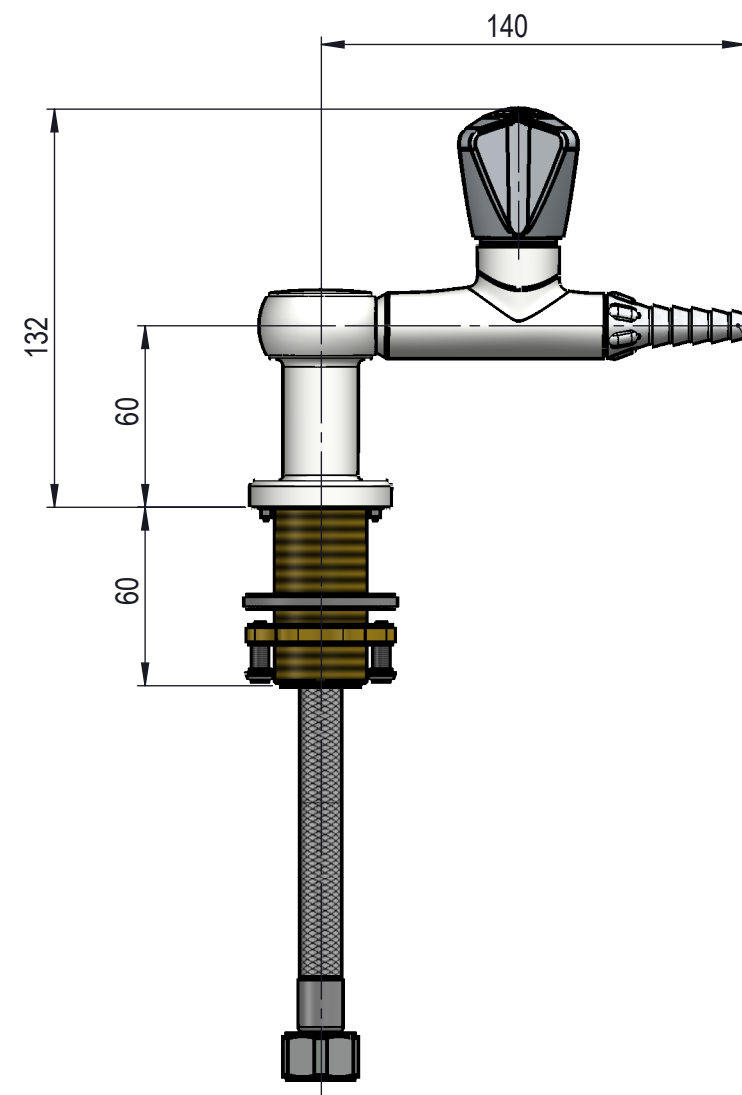

Fixed Polypropylene nozzle

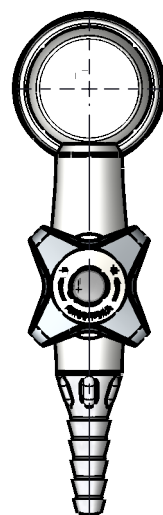
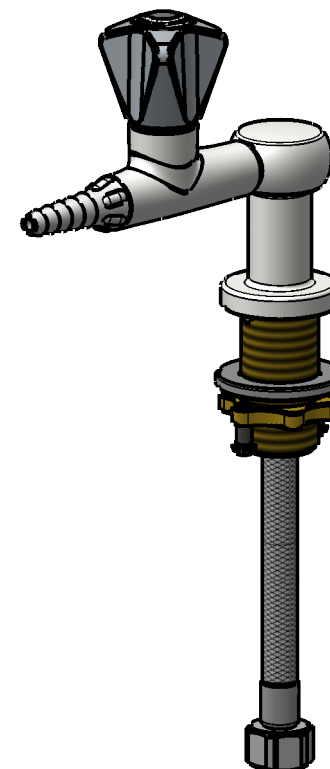

MEDIA CODE XX FOR  
VACUUM

\*Model shown for V

Media	Media description	Media code XX
V	Vacuum Low	28
VF	Vacuum Fine	29
VH	Vacuum High	30

Description:	1-Valve, Turret, 1-Hole, Fix. Nozzle, M30x1,5mm, Hose
--------------	---

							Media:	Vacuum & Highflow		
							Comments:			
							Drawing type:	Customer drawing		Weight: 1.014 K
Rev.	Pos.	Date	TM No.	Design by	Drawn by:	Change:	Designed by:	Drawn by:	Released on TM No.	Date (DD-MM-YY):
							VJE	MWA		10-08-20
<b>BROEN-LAB</b>						This drawing is our property and cannot be given to a third party, copied or otherwise used without our permission. BROEN-LAB A/S.	Format:	Drawing No.: 253200210XX-52E		
							A3			

# BROEN-LAB

This drawing is our property and cannot be given to a third party, copied or otherwise used without our permission. BROEN-LAB A/S.

Format:	Drawing No.:	253200210XX-52E
A3		