

Area of Application:
Panel mounted
Water

Max. working pressure 10 bar
Min. temperature 5°C
Max. temperature 65°C

Details:
Rubber sealed headwork open/close 2x360°
3-Zone colour, acc. to EN13792:2002

Removable nozzle

Materials in media contact:
Brass
PP
Rubber, EPDM
Silicone based lubricant

Mounting:
RWC

Inlet / outlet connection:
UniFlex
DIN 12 898 hose nozzle

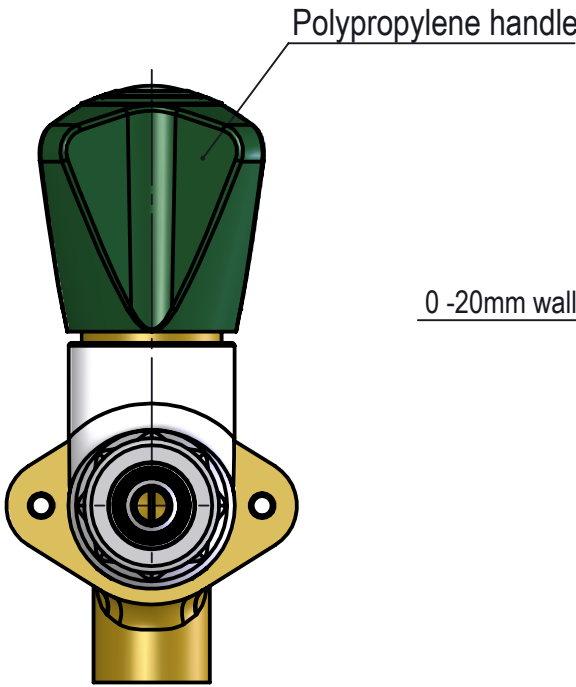

0 -20mm wall thickness

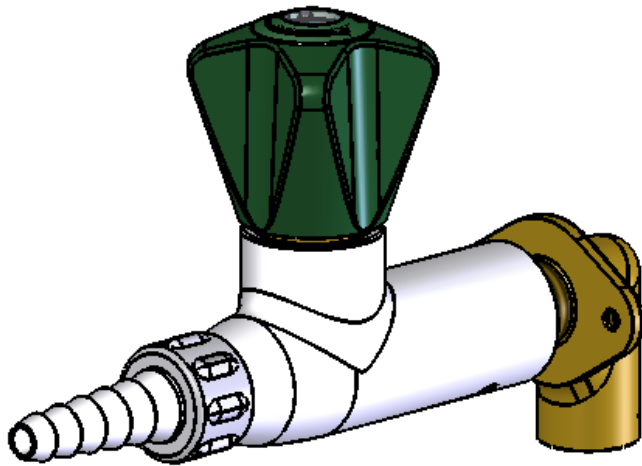
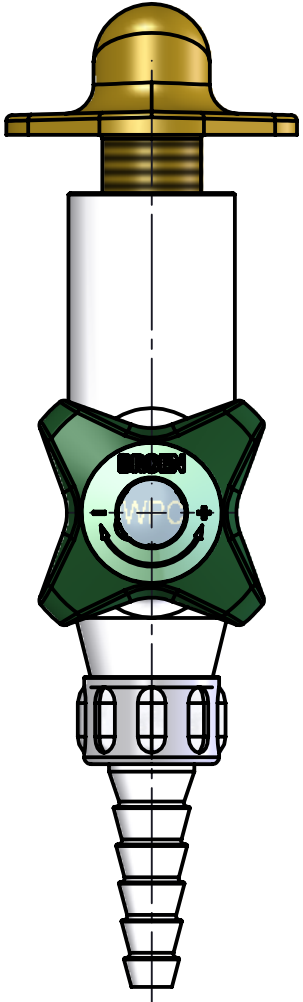
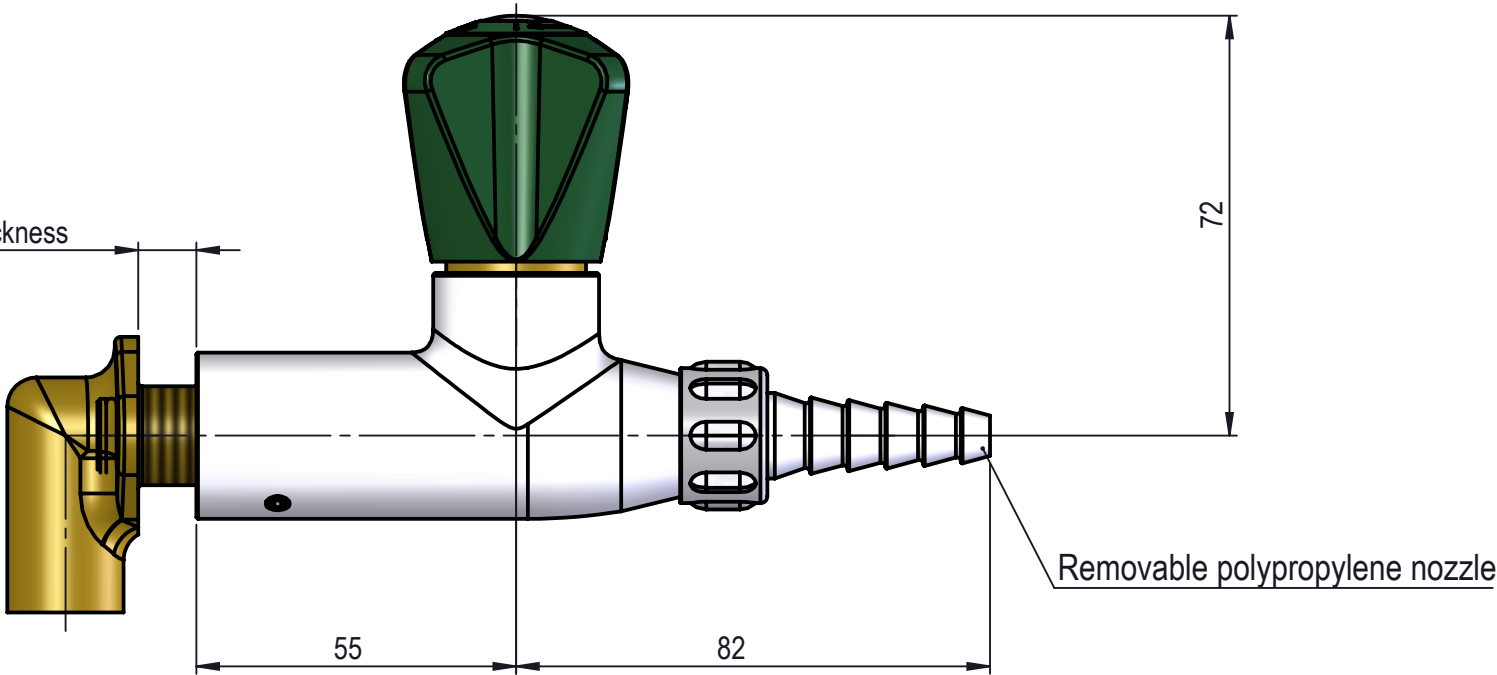

MEDIA CODE XX FOR WATER
ONE MEDIA FITTING
ACCORDING TO EN 13792

| Media | Media description | Media code XX |
|-------|-------------------------|---------------|
| WPC | Water potable cold | 01 |
| WPH | Water potable hot | 02 |
| WCF | Water coolant, feed | 05 |
| WCR | Water coolant, return | 06 |
| WNC | Water non-potable, cold | 07 |
| WNH | Water non-potable, hot | 08 |

Description: 1-Valve, Panel mounted, 1-Hole, Fixed, UniFlex

| | | | | | | | | | |
|------|------|------|--------|-----------|-----------|---------|--------------|---------------|--------------------|
| | | | | | | | | Media: | Water |
| | | | | | | | | Comments: | |
| | | | | | | | | Drawing type: | Customer drawing |
| | | | | | | | | Weight: | 0.627 Kg |
| Rev. | Pos. | Date | TM No. | Design by | Drawn by: | Change: | Designed by: | Drawn by: | Released on TM No. |
| | | | | | | | BJP | MWA | |
| | | | | | | | | | Date: |
| | | | | | | | | | 15-05-2017 |
| | | | | | | | Format: | Drawing No.: | |
| | | | | | | | A3 | | 253222281XX-40 |

BROEN-LAB

This drawing is our property and cannot be given to a third party, copied or otherwise used without our permission. BROEN-LAB A/S.